

梁正志养殖塘勘测定界图

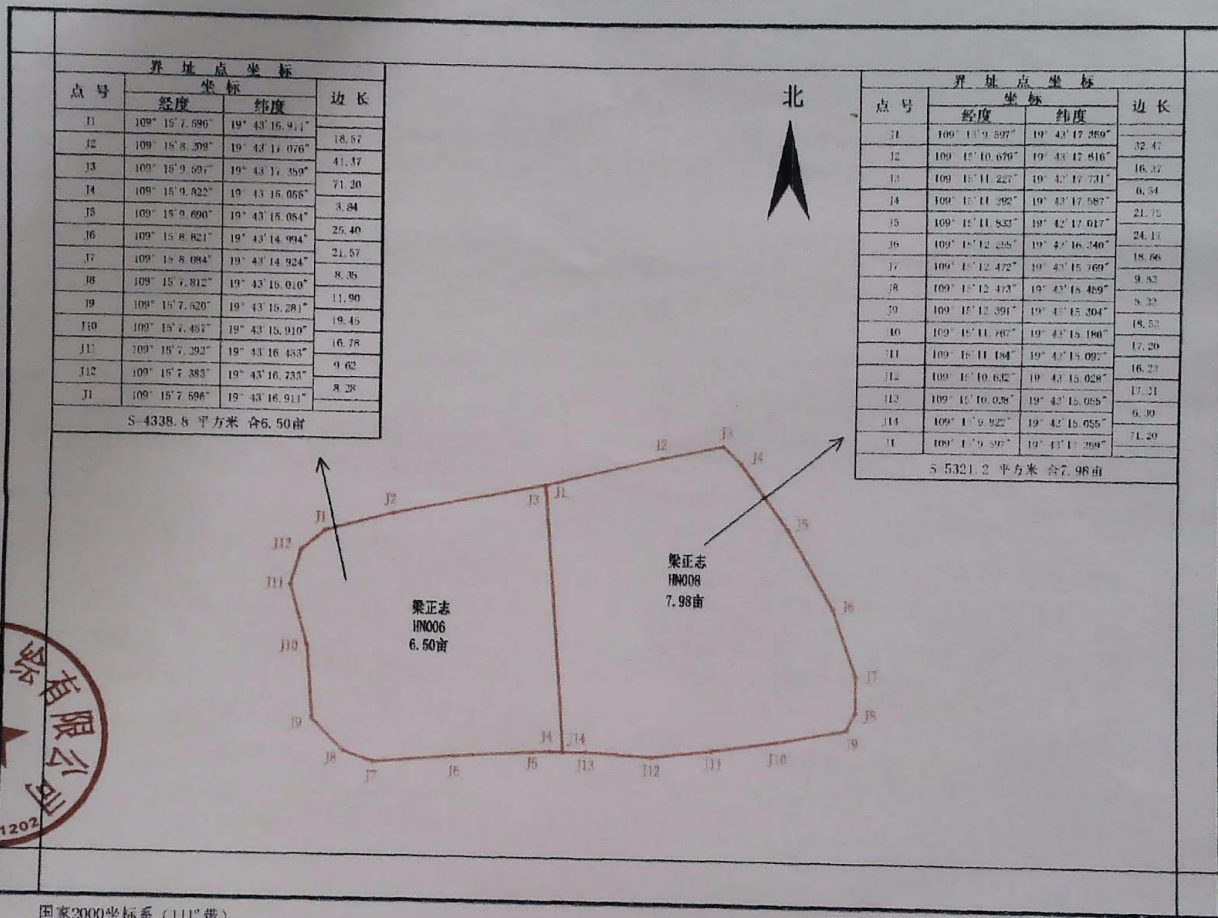

点号	界址点坐标		边长
	经度	纬度	
J1	109° 15' 7.596"	19° 43' 16.911"	18.57
J2	109° 15' 8.309"	19° 43' 14.076"	41.37
J3	109° 15' 9.607"	19° 43' 11.359"	71.20
J4	109° 15' 9.822"	19° 43' 15.055"	3.84
J5	109° 15' 9.690"	19° 43' 15.054"	25.40
J6	109° 15' 8.821"	19° 43' 14.994"	21.57
J7	109° 15' 8.084"	19° 43' 14.924"	8.35
J8	109° 15' 7.812"	19° 43' 15.010"	11.90
J9	109° 15' 7.620"	19° 43' 15.281"	19.45
J10	109° 15' 7.451"	19° 43' 15.910"	16.78
J11	109° 15' 7.292"	19° 43' 16.433"	9.62
J12	109° 15' 7.383"	19° 43' 16.233"	8.28
J11	109° 15' 7.696"	19° 43' 16.911"	

S=4338.8 平方米 合6.50亩

点号	界址点坐标		边长
	经度	纬度	
J1	109° 15' 9.697"	19° 43' 17.359"	32.47
J2	109° 15' 10.670"	19° 43' 17.816"	16.37
J3	109° 15' 11.227"	19° 43' 17.731"	6.34
J4	109° 15' 11.392"	19° 43' 17.587"	21.75
J5	109° 15' 11.833"	19° 43' 17.617"	24.11
J6	109° 15' 12.255"	19° 43' 16.340"	18.66
J7	109° 15' 12.472"	19° 43' 15.769"	9.82
J8	109° 15' 12.473"	19° 43' 15.489"	8.32
J9	109° 15' 12.391"	19° 43' 15.204"	18.52
J10	109° 15' 11.767"	19° 43' 15.180"	17.29
J11	109° 15' 11.184"	19° 43' 15.097"	16.23
J12	109° 15' 10.652"	19° 43' 15.029"	17.21
J13	109° 15' 10.028"	19° 43' 15.055"	6.30
J14	109° 15' 9.922"	19° 43' 15.655"	71.20
J1	109° 15' 9.697"	19° 43' 17.359"	

S=5321.2 平方米 合7.98亩



国家2000坐标系 (111°带)
1985国家高程
G1/T20257.1-2017
2022年02月16日

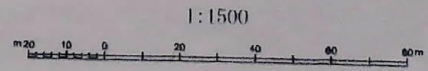

测量员: 李万贤
绘图员: 羊振耀
审图员: 徐毅彬